

Design Title :  
Revision Level :  
Approved by :  
Designer :  
Company :  
Address :  
E-Mail :  
Phone :  
Date : 2020-04-07

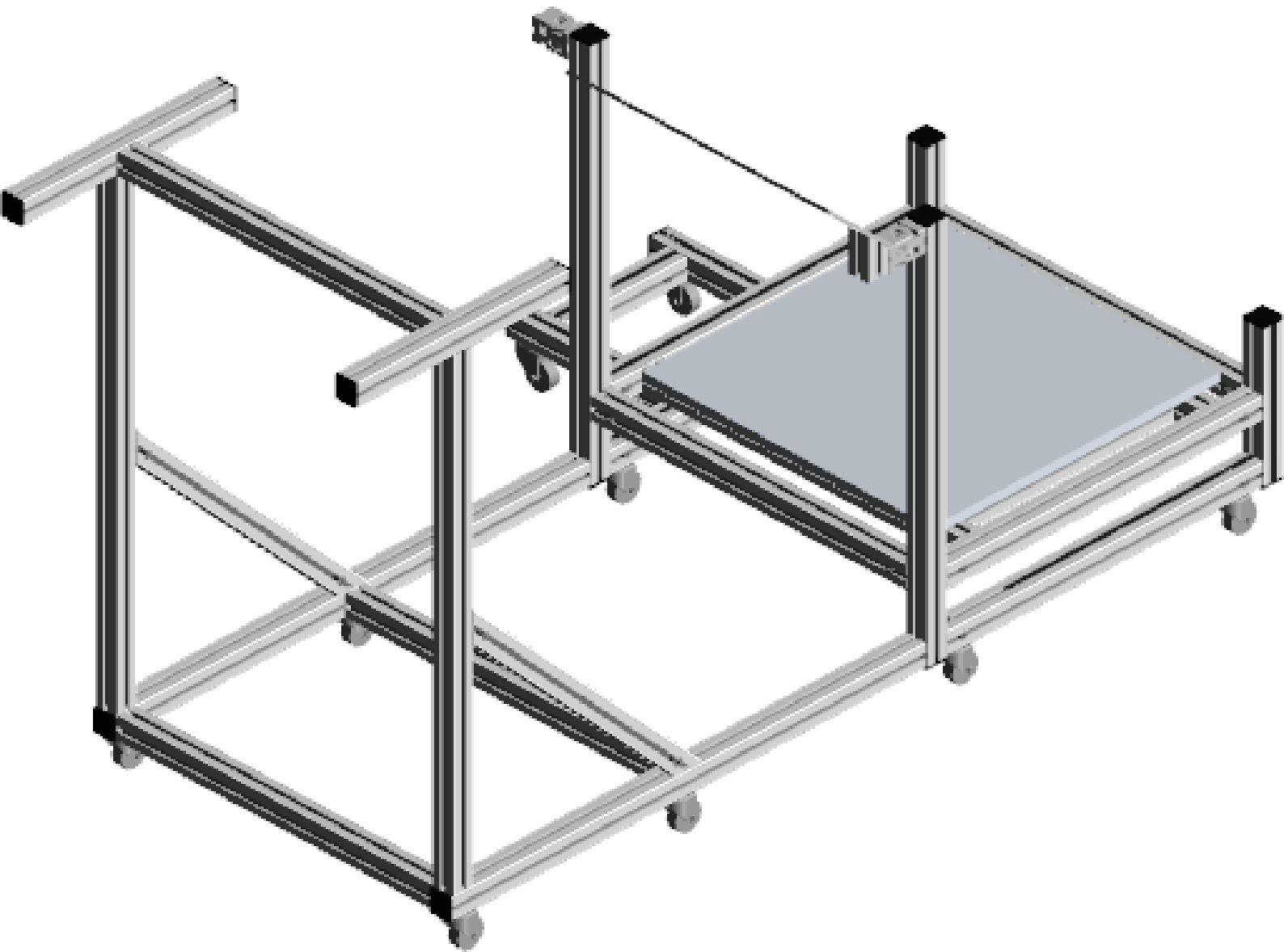

Bill of materials (Number of kits: 1)

Pos	Article-No	Description	Units	Qty	Each €	Price €
1	1.11.040040.43LP-A00C00/75	Profile 40x40, 4E, light, plain Special angle, Right: 42.0°; ***PER DRAWING 1***	MM	1	2.47	2.47
2	1.11.040040.43LP-AA4AA4/230	Profile 40x40, 4E, light, plain	MM	1	7.48	7.48
3	1.11.040040.43LP-AA4AA4/600	Profile 40x40, 4E, light, plain ***PER DRAWING 2***	MM	1	15.26	15.26
3.A	Q10A1I07161-12.0	Cross bore, left    Ø 12.0 mm, distance 50.0 mm, Side: 1	EA	1		0.00
3.B	Q10A1I07161-12.0	Cross bore, left    Ø 12.0 mm, distance 580.0 mm, Side: 1	EA	1		0.00
4	1.11.040040.43LP-AA4AA4/600	Profile 40x40, 4E, light, plain ***PER DRAWING 3***	MM	1	15.26	15.26
4.A	Q10A1I07161-12.0	Cross bore, left    Ø 12.0 mm, distance 50.0 mm, Side: 1	EA	1		0.00
4.B	Q10A1I07161-12.0	Cross bore, left    Ø 12.0 mm, distance 580.6 mm, Side: 1	EA	1		0.00
5	1.11.040040.43LP-AA4A00/900	Profile 40x40, 4E, light, plain ***PER DRAWING 4***	MM	1	17.64	17.64
5.A	Q10A4I07161-12.0	Cross bore, left    Ø 12.0 mm, distance 465.3 mm, Side: 4	EA	1		0.00
5.B	Q10A4I07161-12.0	Cross bore, left    Ø 12.0 mm, distance 880.0 mm, Side: 4	EA	1		0.00
6	1.11.040040.43LP-AA4A00/900	Profile 40x40, 4E, light, plain ***PER DRAWING 5***	MM	1	17.64	17.64
6.A	Q10A4I07161-12.0	Cross bore, left    Ø 12.0 mm, distance 445.0 mm, Side: 4	EA	1		0.00
6.B	Q10A4I07161-12.0	Cross bore, left    Ø 12.0 mm, distance 880.0 mm, Side: 4	EA	1		0.00
7	1.11.040040.43LP-A00A00/250	Profile 40x40, 4E, light, plain	MM	2	4.73	9.47
8	1.11.040040.43LP-AA4A00/300	Profile 40x40, 4E, light, plain ***PER DRAWING 6***	MM	2	8.38	16.76
8.A	Q10A3I07161-12.0	Cross bore, left    Ø 12.0 mm, distance 280.6 mm, Side: 3	EA	2		0.00
9	1.11.040040.43LP-A00A00/400	Profile 40x40, 4E, light, plain	MM	2	6.67	13.35
10	1.11.040040.43LP-AA4AA4/415	Profile 40x40, 4E, light, plain	MM	2	9.87	19.74
11	1.11.040040.43LP-EA3EA3/619.8	Profile 40x40, 4E, light, plain ***PER DRAWING 7***	MM	2	14.02	28.04
12	1.11.040040.43LP-A00A00/700	Profile 40x40, 4E, light, plain	MM	2	10.56	21.11
13	1.11.040040.43LP-AA4AA4/860	Profile 40x40, 4E, light, plain	MM	2	15.62	31.25

Bill of materials (Number of kits: 1)

Pos	Article-No	Description	Units	Qty	Each €	Price €
14	1.11.040040.43LP-AA4AA4/600	Profile 40x40, 4E, light, plain	MM	9	12.26	110.35
17	1.41.11.2	Cover profile 10, PVC, F/ E, black (bar 2.5 m)	EA	2	2.98	5.96
18	1.42.20404.2	Cover cap 40x40, dia: 12, black	EA	16	0.96	15.36
19	1.45.21050	Swivel castor with bolt hole, dia: 50	EA	10	7.09	70.90
20	1.63.04041	Joint 40x40	EA	2	47.86	95.72
21	0.63.D06912.08016	Cylindric head screw, DIN 6912 - M8x16	EA	3	0.18	0.54
22	0.63.D06912.10030	Cylindric head screw, DIN 6912 - M10x30	EA	10	0.18	1.80
23	1.21.4E0	Connector, universal	EA	36	2.30	82.80
24	1.21.4EK1	Connector, oblique-hinge l. + r.	EA	4	4.55	18.20
25	1.32.4EM8	T-Nut for subsequent insertion, w. spring E, M8	EA	3	1.13	3.39
26	1.35.610395	Press-fit threaded insert dia: 12/M10, L42.5	EA	10	5.61	56.10
27	1.63.04042	Anti-twist device for joint, L40	EA	2	5.85	11.70
		Frame weight:	26.75 kg (58.98 lbs)		Frame price:	€ 688.29
15	1.82.163-99	Chipboard 16 mm, similar to RAL 7035, SIZE: 550.00MM x 550.00MM ***PER DRAWING 8***	SM	1	14.29	14.29
16	1.85.060-99	Alu-plastic composite panel 6 mm, SIZE: 200.00MM x 500.00MM ***PER DRAWING 9***	SM	1	22.19	22.19
		Panels weight:	4.12 kg (9.08 lbs)		Panels price:	€ 36.48
		Total Weight:	30.87 kg (68.06 lbs)		Total (EURO):	€ 724.77
* The price indicated above, does not include assembly, packaging, taxes and transport.						

## Isometric view

Some accessories may not be shown

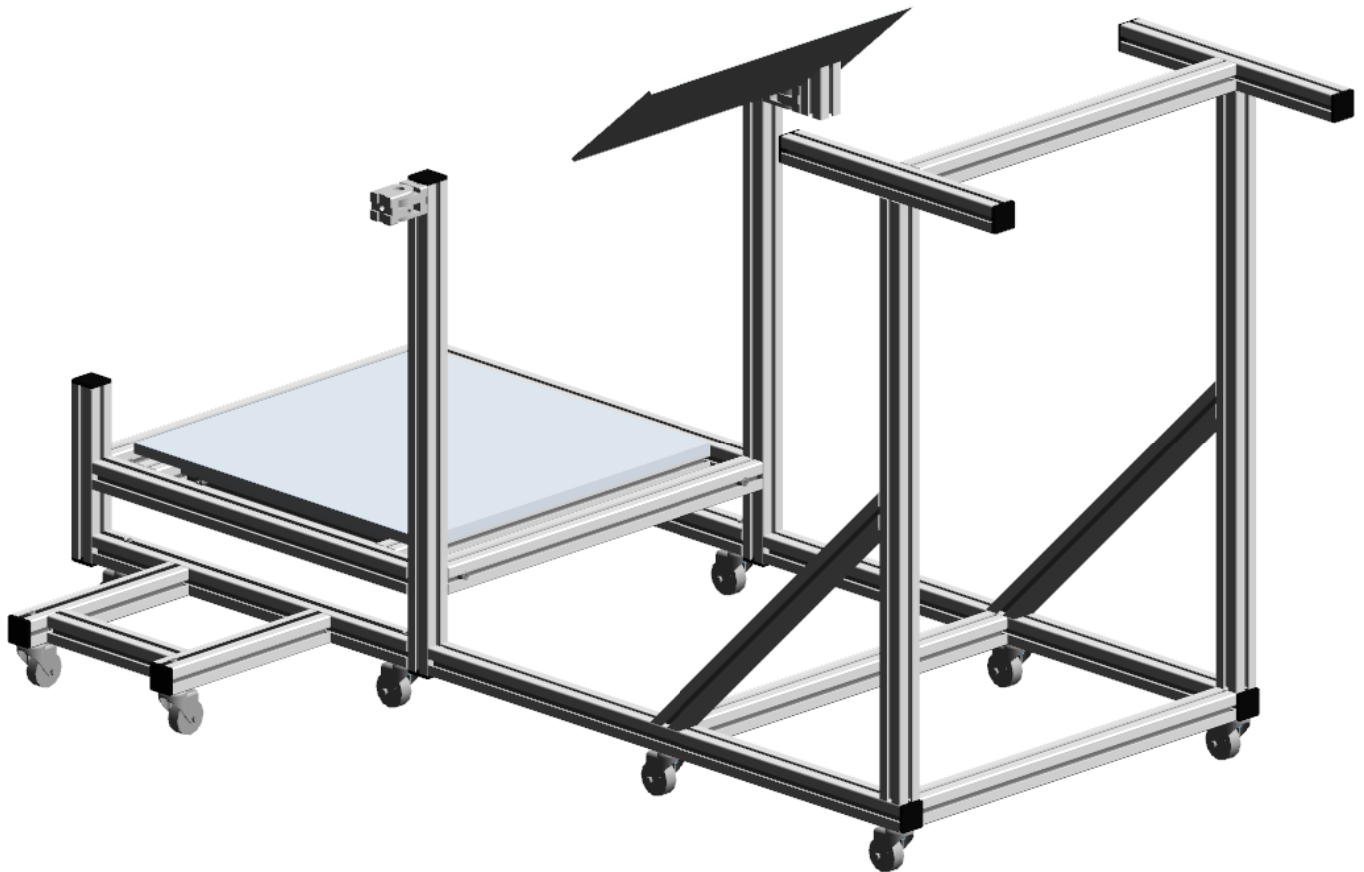

Multiview

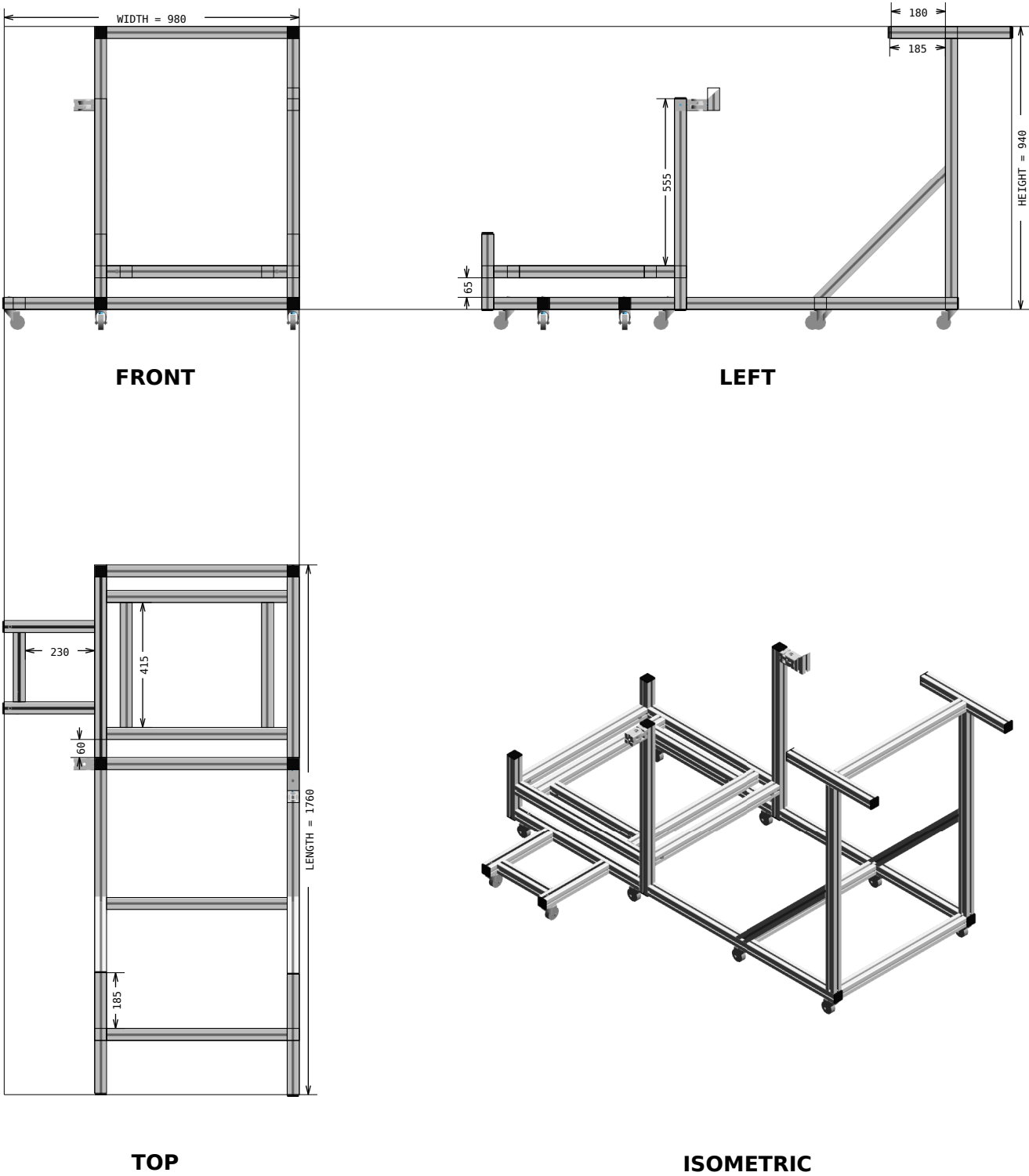

Exploded view

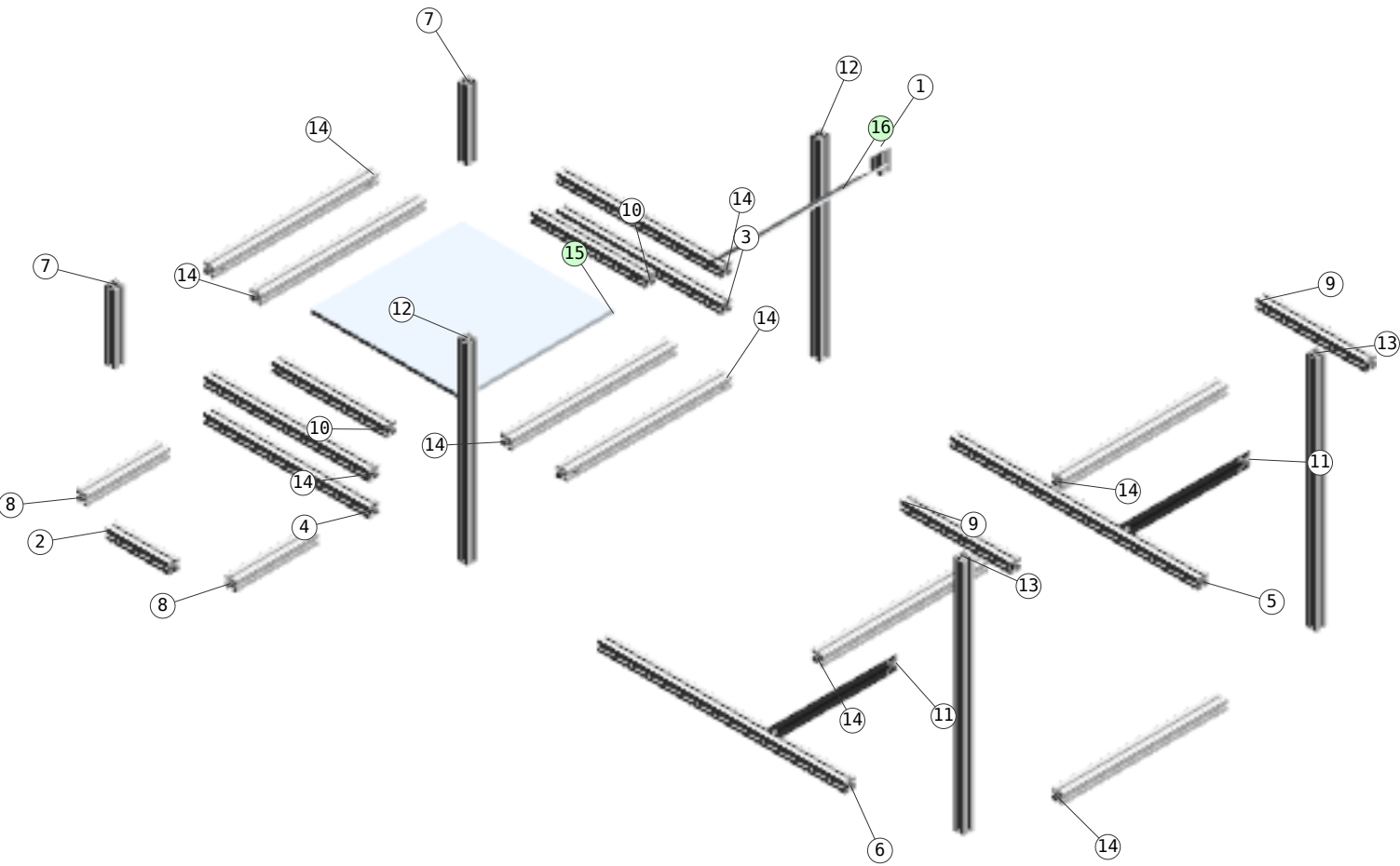

# Assembly List

Pos	Article-No	Description	Related parts	Qty
2	1.11.040040.43LP-AA4AA4/230	Profile 40x40, 4E, light, plain	1.21.4E0, Connector, universal	2
3	1.11.040040.43LP-AA4AA4/600	Profile 40x40, 4E, light, plain	1.21.4E0, Connector, universal	2
4	1.11.040040.43LP-AA4AA4/600	Profile 40x40, 4E, light, plain	1.21.4E0, Connector, universal	2
5	1.11.040040.43LP-AA4A00/900	Profile 40x40, 4E, light, plain	1.21.4E0, Connector, universal	1
6	1.11.040040.43LP-AA4A00/900	Profile 40x40, 4E, light, plain	1.21.4E0, Connector, universal	1
8	1.11.040040.43LP-AA4A00/300	Profile 40x40, 4E, light, plain	1.21.4E0, Connector, universal	2
10	1.11.040040.43LP-AA4AA4/415	Profile 40x40, 4E, light, plain	1.21.4E0, Connector, universal	4
11	1.11.040040.43LP-EA3EA3/619.8	Profile 40x40, 4E, light, plain	1.21.4EK1, Connector, oblique-hinge l. + r.	4
13	1.11.040040.43LP-AA4AA4/860	Profile 40x40, 4E, light, plain	1.21.4E0, Connector, universal	4
14	1.11.040040.43LP-AA4AA4/600	Profile 40x40, 4E, light, plain	1.21.4E0, Connector, universal	18
19	1.45.21050	Swivel castor with bolt hole, dia: 50	0.63.D06912.10030, Cylindric head screw, DIN 6912 - M10x30 1.35.610395, Press-fit threaded insert dia: 12/M10, L42.5	10 10
20	1.63.04041	Joint 40x40	1.32.4EM8, T-Nut for subsequent insertion, w. spring E, M8 0.63.D06912.08016, Cylindric head screw, DIN 6912 - M8x16 1.63.04042, Anti-twist device for joint, L40	3 3 2

# Profile machining details

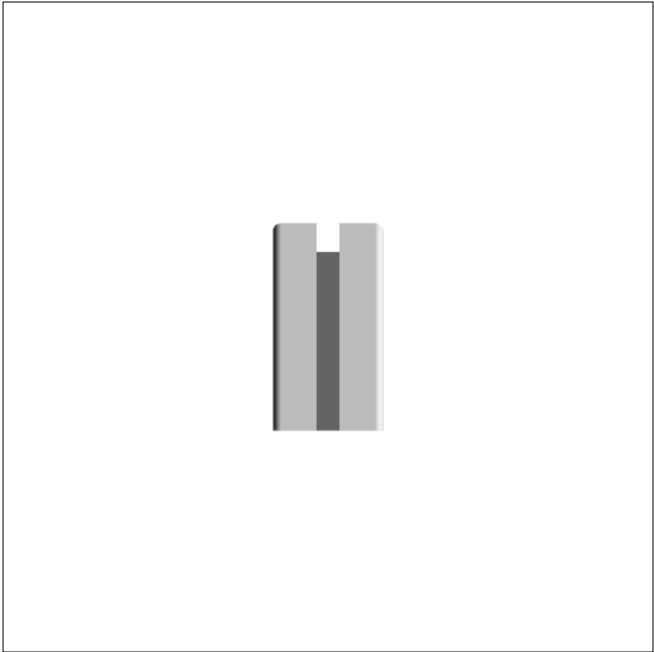

**DRAWING 1, Pos 1**  
**SIDE 1, bar length: 75.0 mm**

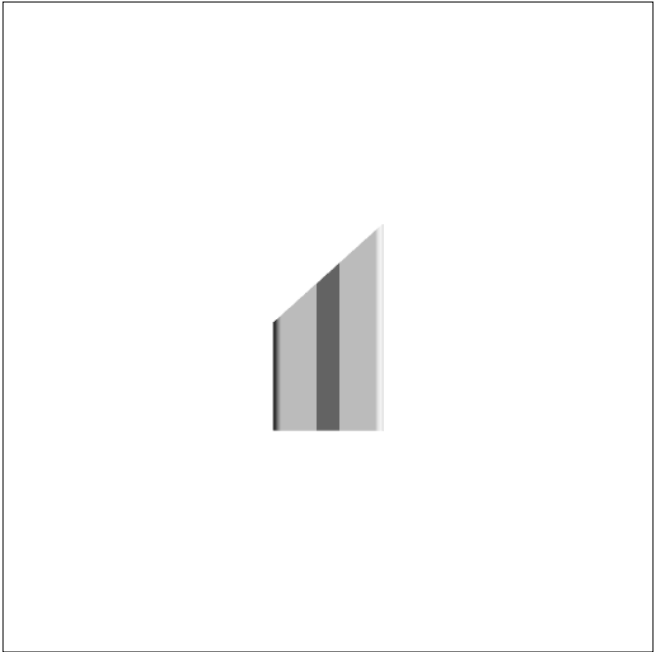

**DRAWING 1, Pos 1**  
**SIDE 2**

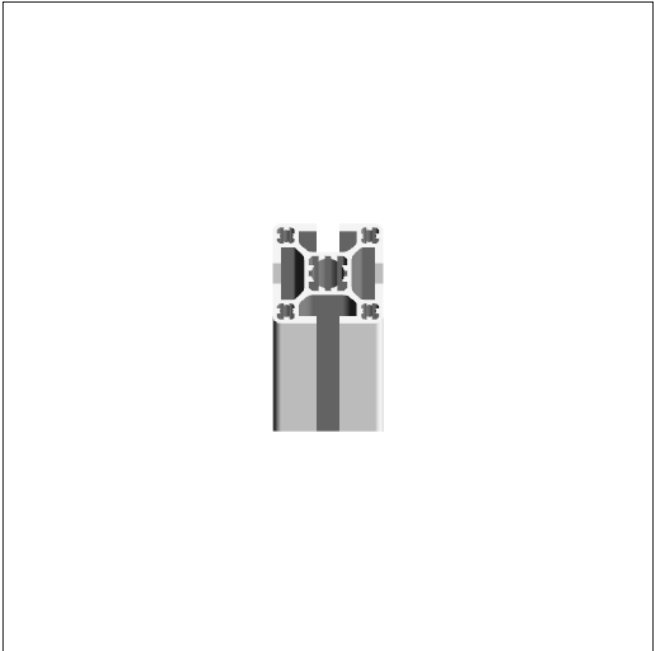

**DRAWING 1, Pos 1**  
**SIDE 3**

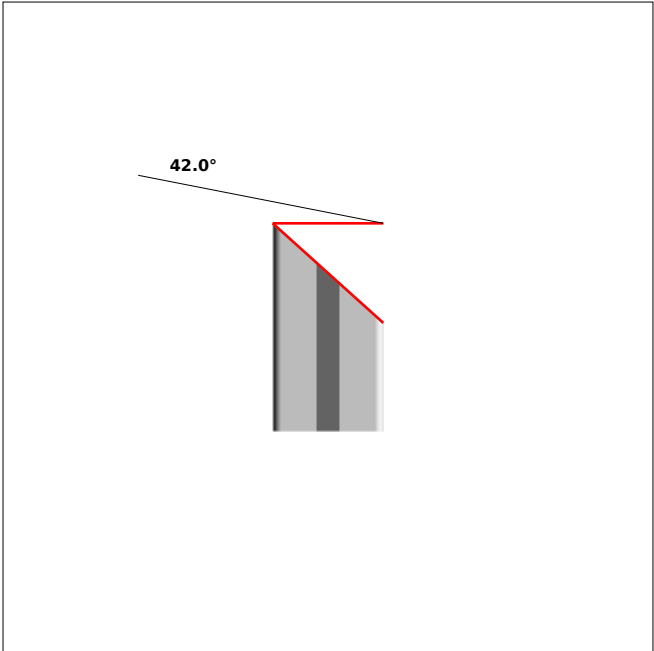

**DRAWING 1, Pos 1**  
**SIDE 4**

← Profile "left end" is always at the bottom of the drawing. All dimensions are from "left".



# Profile machining details

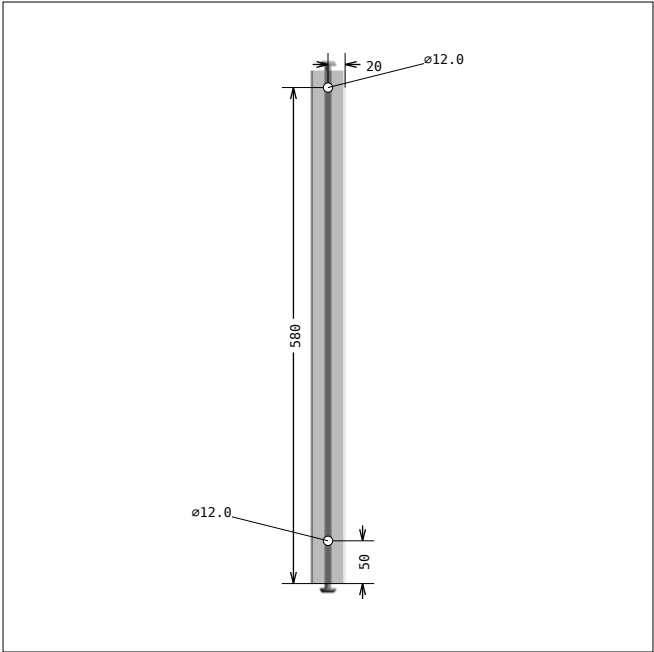

**DRAWING 2, Pos 3**  
**SIDE 1, bar length: 600.0 mm**

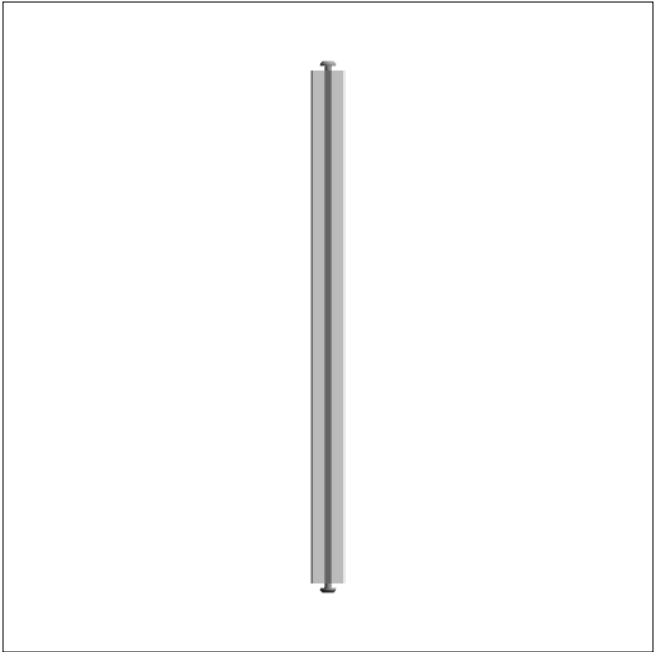

**DRAWING 2, Pos 3**  
**SIDE 2**

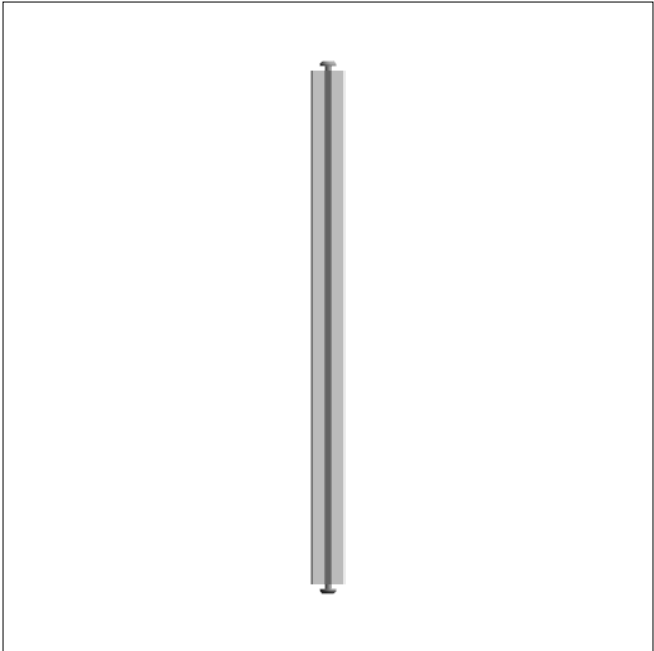

**DRAWING 2, Pos 3**  
**SIDE 3**

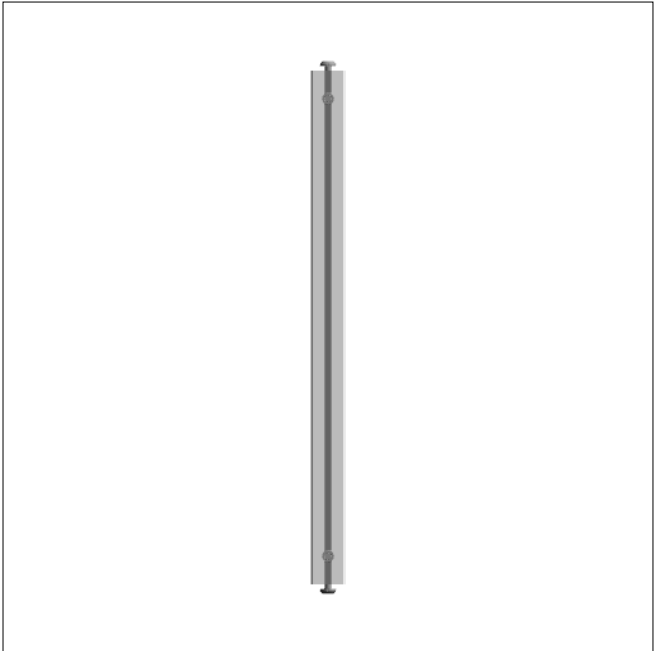

**DRAWING 2, Pos 3**  
**SIDE 4**

← Profile "left end" is always at the bottom of the drawing. All dimensions are from "left".

# Profile machining details

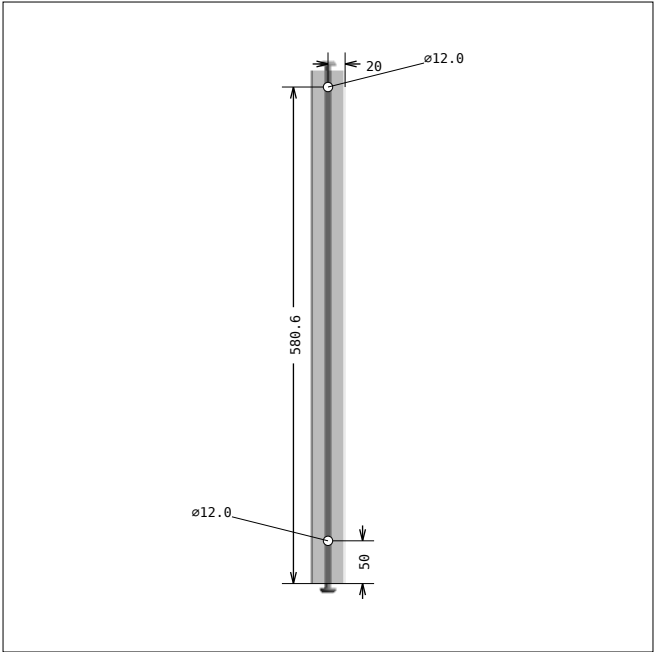

**DRAWING 3, Pos 4**  
**SIDE 1, bar length: 600.0 mm**

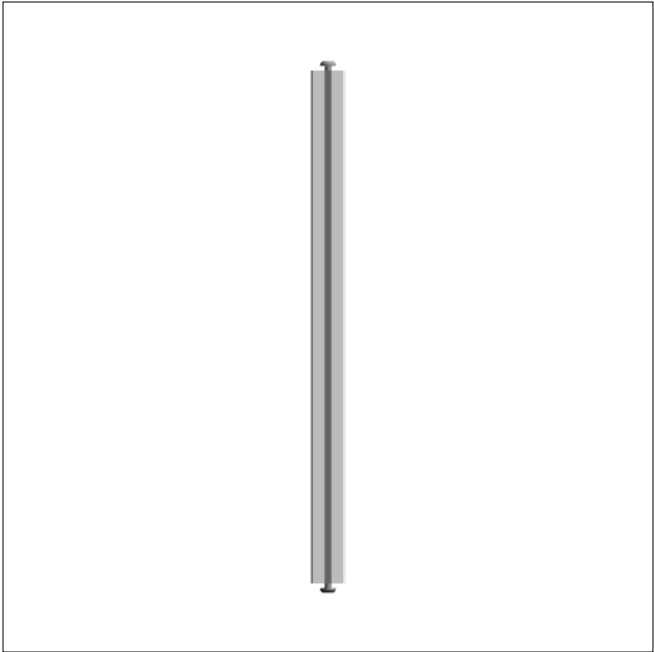

**DRAWING 3, Pos 4**  
**SIDE 2**

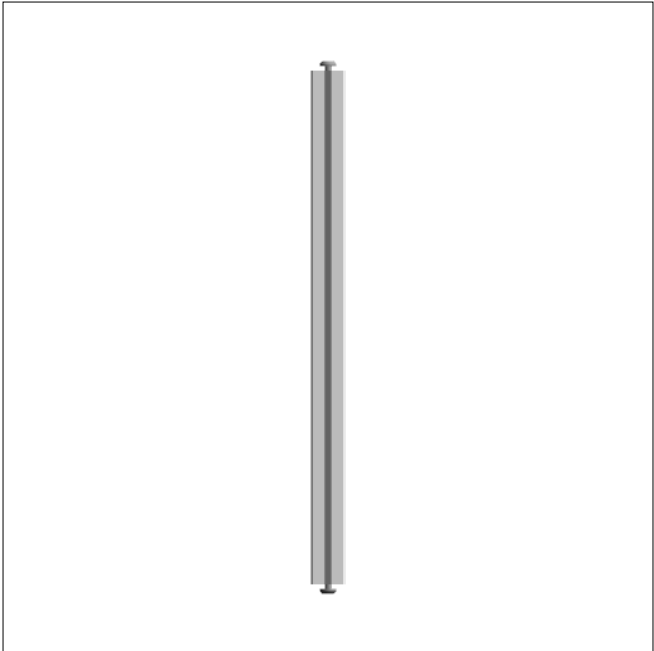

**DRAWING 3, Pos 4**  
**SIDE 3**

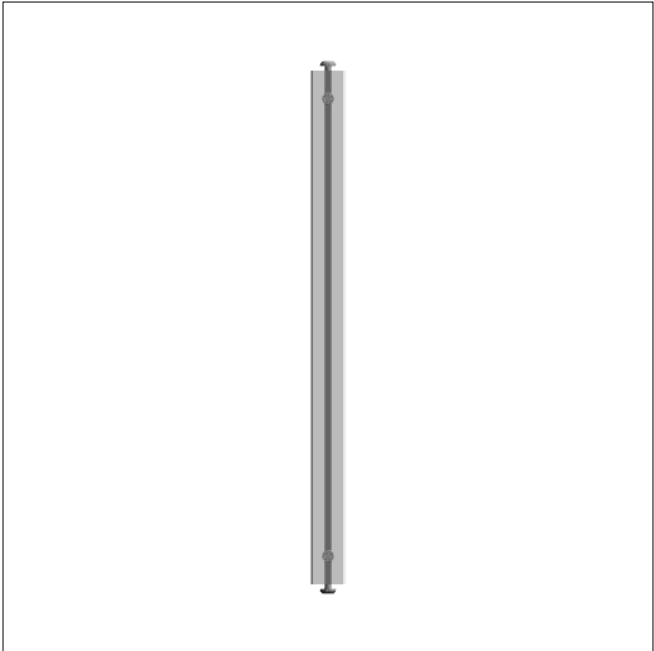

**DRAWING 3, Pos 4**  
**SIDE 4**

← Profile "left end" is always at the bottom of the drawing. All dimensions are from "left".

# Profile machining details

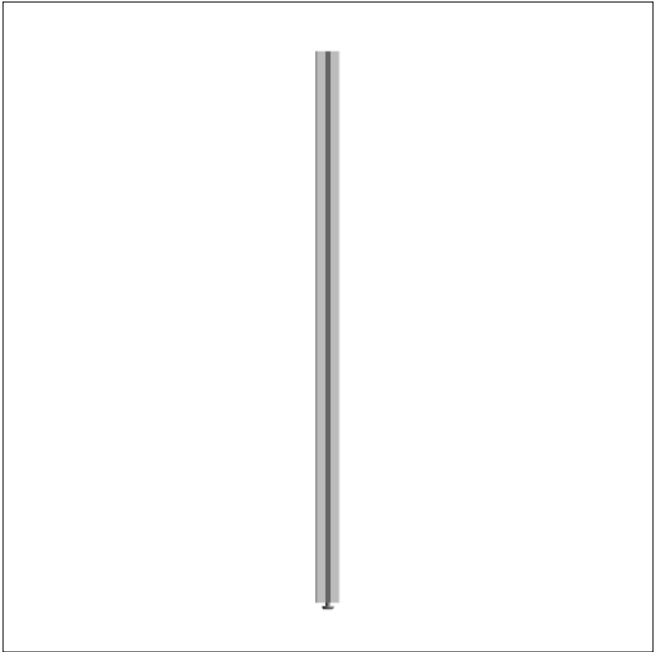

**DRAWING 4, Pos 5  
SIDE 1, bar length: 900.0 mm**

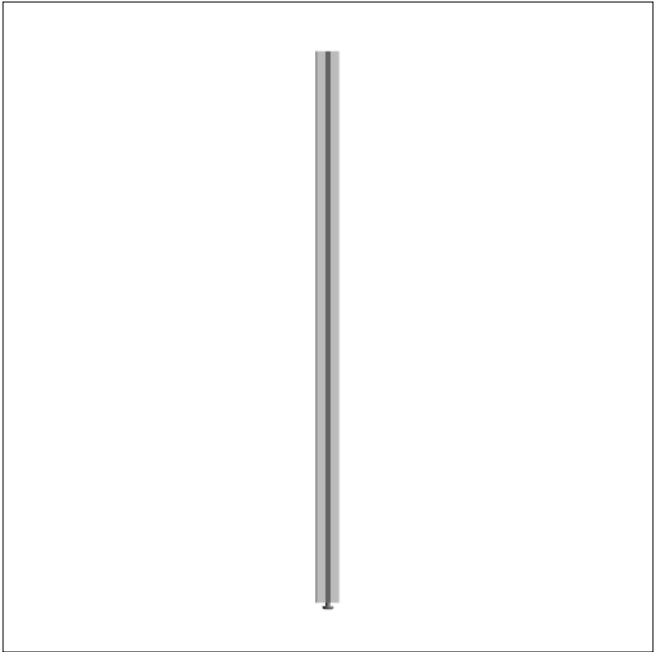

**DRAWING 4, Pos 5  
SIDE 2**

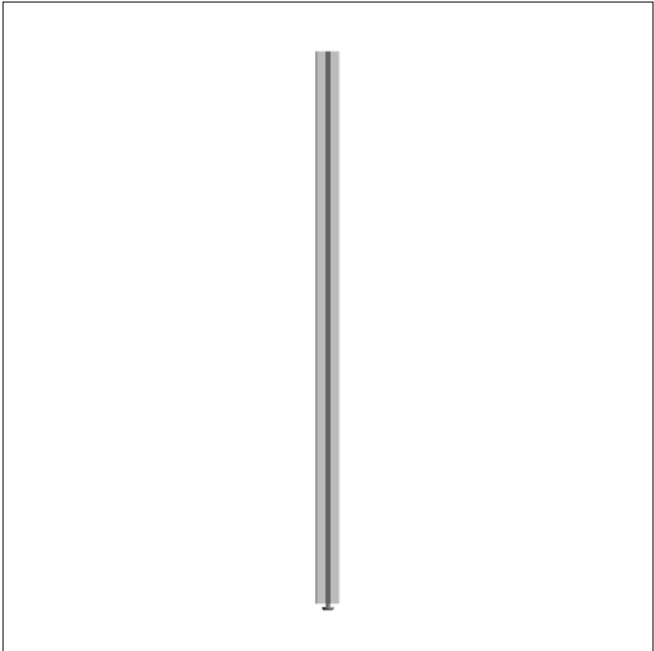

**DRAWING 4, Pos 5  
SIDE 3**

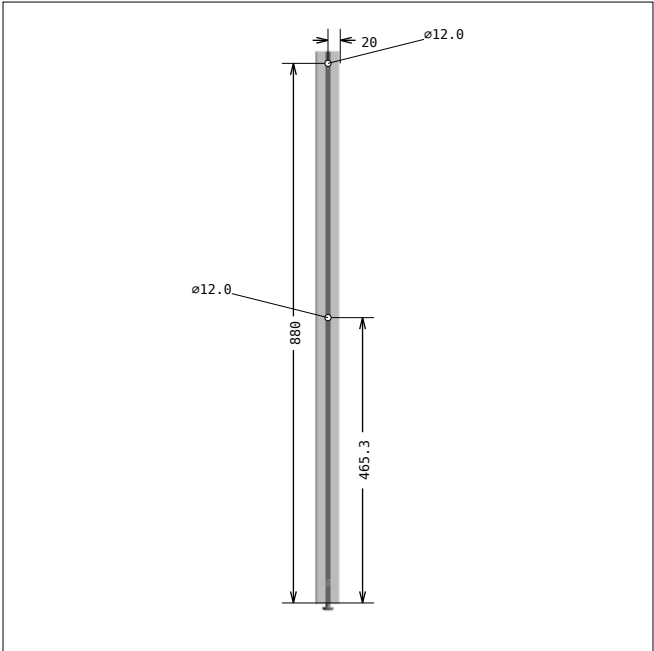

**DRAWING 4, Pos 5  
SIDE 4**

← Profile "left end" is always at the bottom of the drawing. All dimensions are from "left".

# Profile machining details

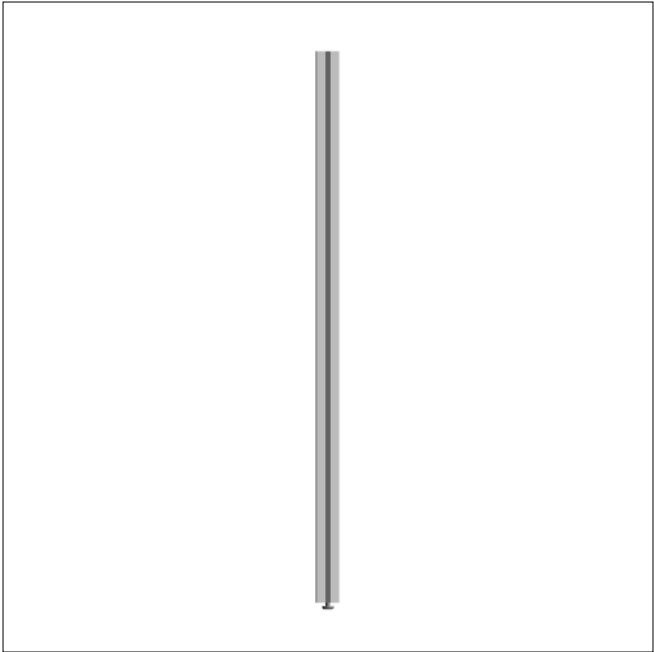

**DRAWING 5, Pos 6  
SIDE 1, bar length: 900.0 mm**

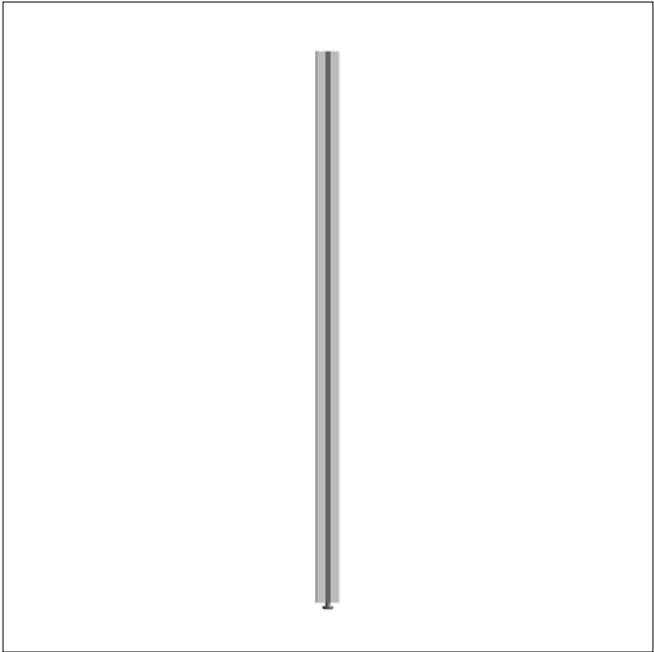

**DRAWING 5, Pos 6  
SIDE 2**

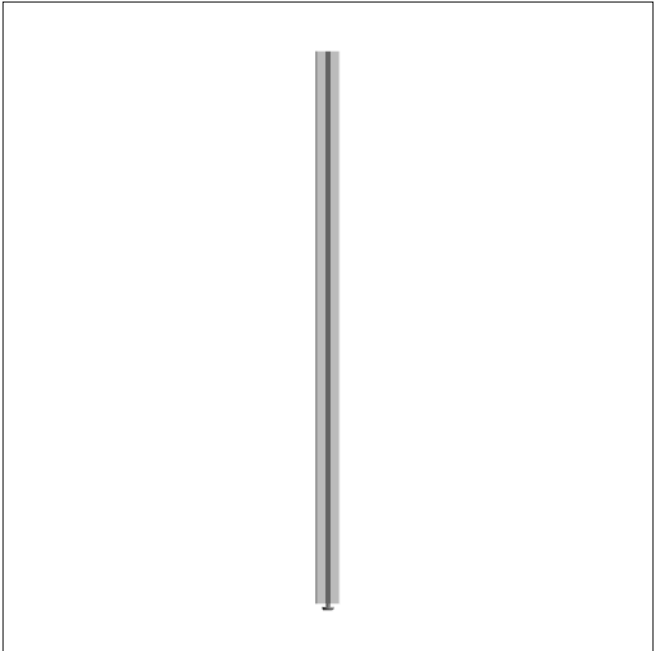

**DRAWING 5, Pos 6  
SIDE 3**

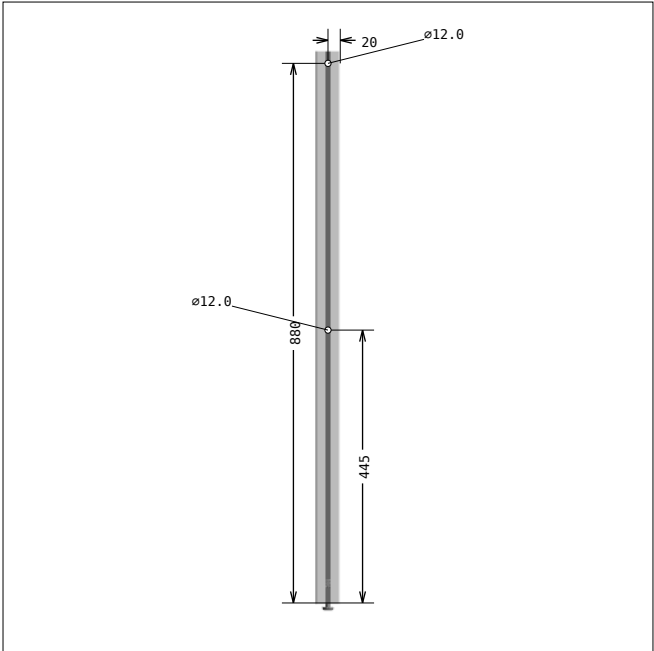

**DRAWING 5, Pos 6  
SIDE 4**

← Profile "left end" is always at the bottom of the drawing. All dimensions are from "left".

# Profile machining details

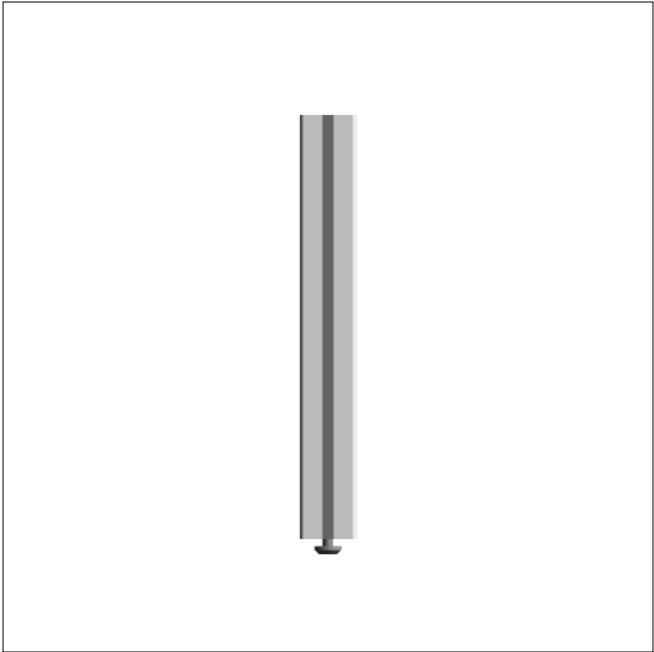

**DRAWING 6, Pos 8  
SIDE 1, bar length: 300.0 mm**

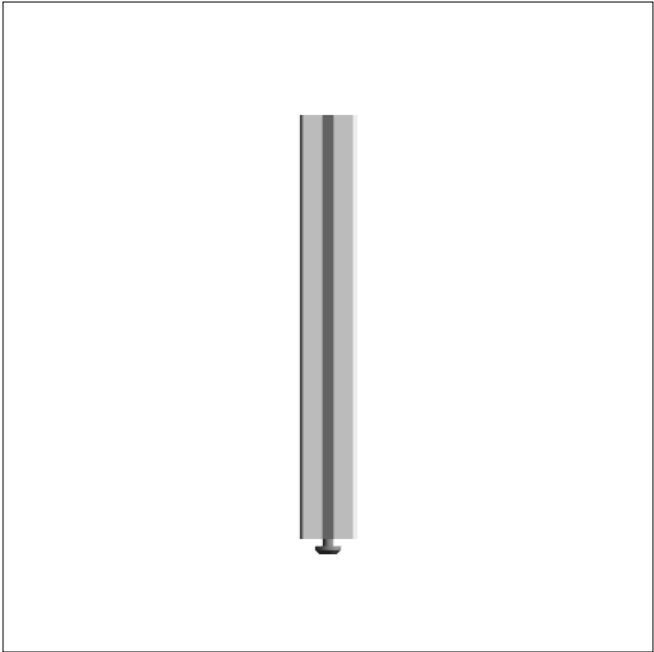

**DRAWING 6, Pos 8  
SIDE 2**

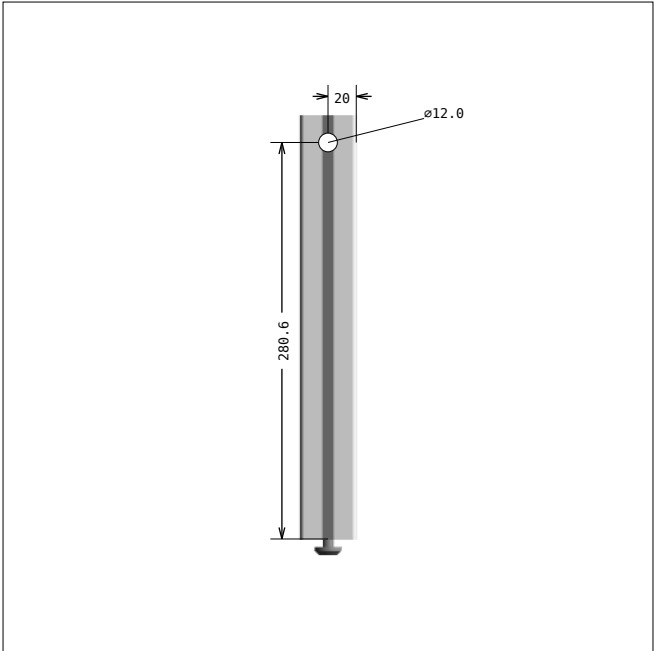

**DRAWING 6, Pos 8  
SIDE 3**

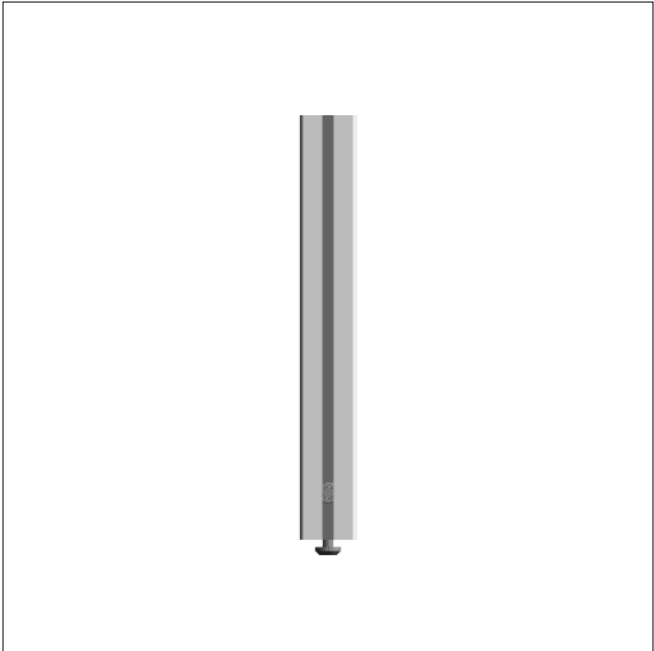

**DRAWING 6, Pos 8  
SIDE 4**

← Profile "left end" is always at the bottom of the drawing. All dimensions are from "left".

# Profile machining details

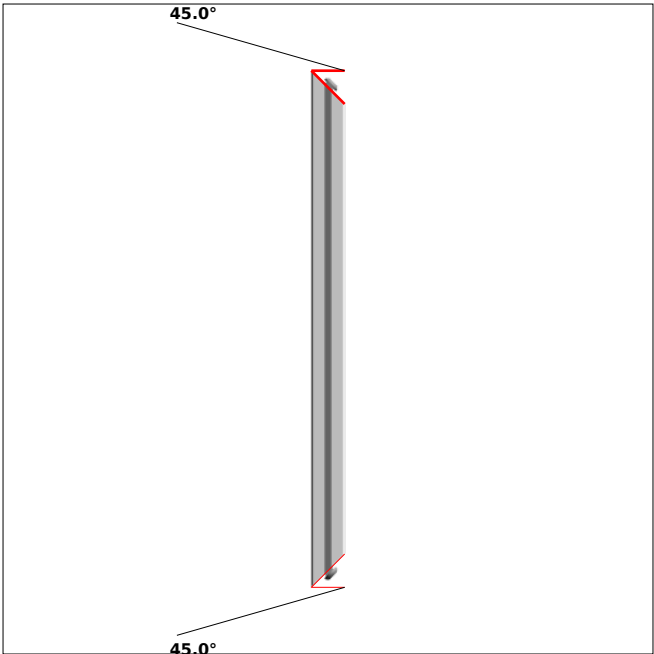

**DRAWING 7, Pos 11**  
**SIDE 1, bar length: 619.8 mm**

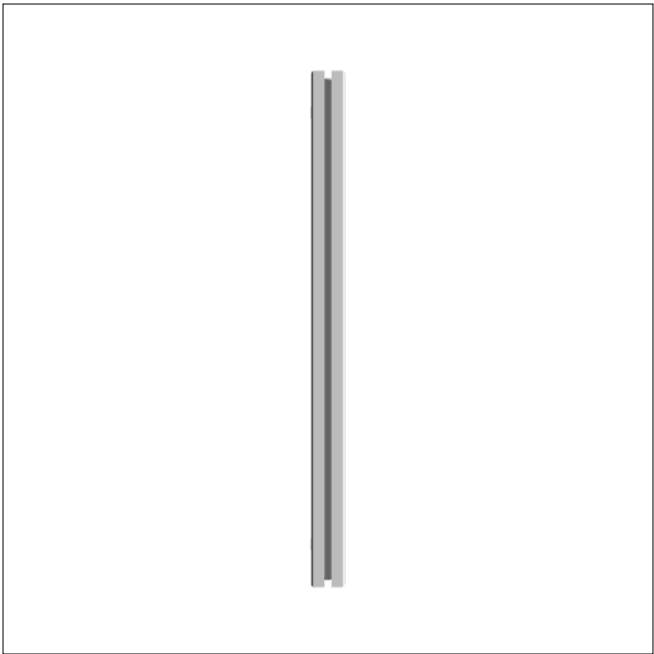

**DRAWING 7, Pos 11**  
**SIDE 2**



**DRAWING 7, Pos 11**  
**SIDE 3**



**DRAWING 7, Pos 11**  
**SIDE 4**

← Profile "left end" is always at the bottom of the drawing. All dimensions are from "left".

# Panels

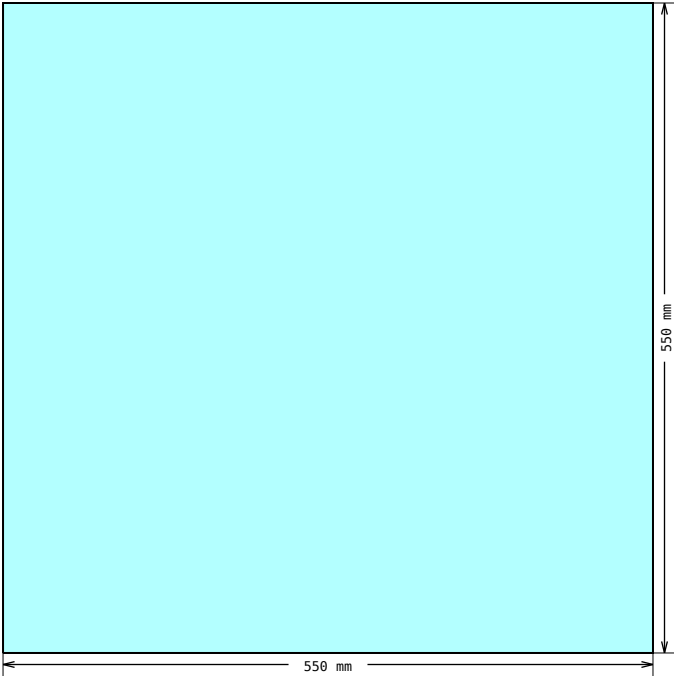

**DRAWING 8, Pos 15**  
**Shape measurements**

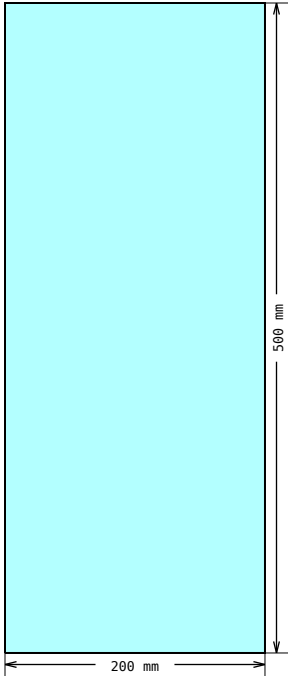

**DRAWING 9, Pos 16**  
**Shape measurements**

# Suggested profile cuts (incl. kerf: 3.5 mm)

Article-No	Cuts	Waste (mm)
1.11.040040.43LP	<div><div><div>10</div><div>11</div><div>12</div><div>12</div><div>13</div><div>13</div><div>6</div><div>5</div></div><div>415.0619.8700.0700.0860.0860.0900.0900.0</div></div>	17.2 mm
	<div><div><div>1</div><div>10</div><div>14</div><div>14</div><div>14</div><div>4</div><div>14</div><div>3</div><div>14</div><div>14</div><div>11</div></div><div>75.0415.0600.0600.0600.0600.0600.0600.0600.0600.0619.8</div></div>	51.7 mm
	<div><div><div>2</div><div>7</div><div>7</div><div>8</div><div>8</div><div>9</div><div>9</div><div>14</div><div>14</div><div>14</div></div><div>230.0250.0250.0300.0300.0400.0400.0600.0600.0600.0</div></div>	2035.0 mm



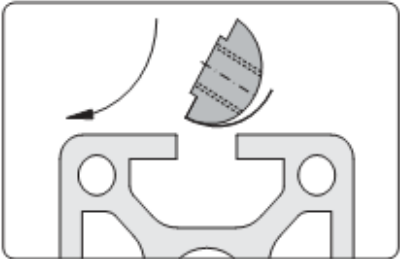

# Assembly hints

ACCESSORY	1.32.4EM8	T-Nut for subsequent insertion, w. spring E, M8
<div></div> <p>Fixing with leaf spring</p> <div></div> <p>Insert front-sided and rotate</p> <div><p><b>Application</b></p><p>Fastening element for screw-type connections</p><p><b>Technical data</b></p><p>Design steel:</p><ul style="list-style-type: none"><li>• material: steel</li><li>• surface: galvanised</li></ul><p>Design stainless:</p><ul style="list-style-type: none"><li>• material: stainless steel 1.4305</li><li>• surface: pickled and passivated</li></ul><p>max. moment of torque: <math>M_{A, max}</math></p></div>		<p>These t-nuts are easily inserted into assembled frames</p>

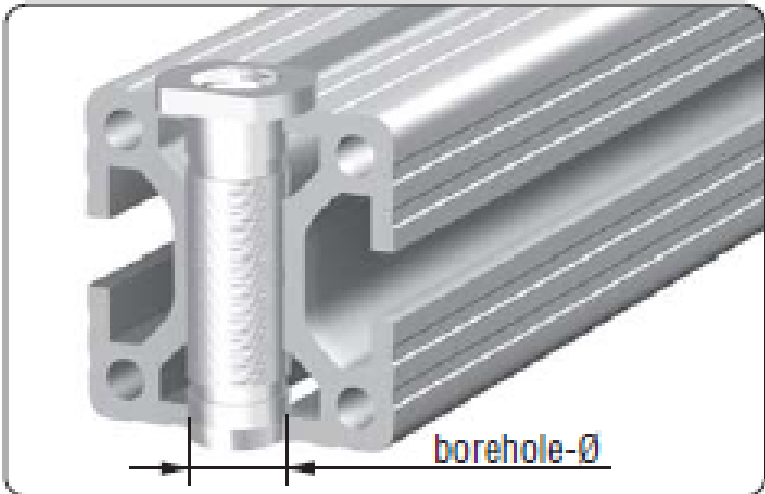
# Assembly hints

None	1.35.610395	Press-fit threaded insert dia: 12/M10, L42.5
		<p>These inserts are used for mounting feet, casters and other hardware. Ideally, you would use the press to insert them, but in some applications you may use a hammer to place them. To avoid thread damage, temporarily install a scrap screw of appropriate size and hammer on the head of the screw, not the insert itself.</p>
		

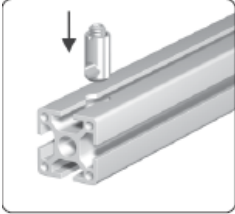
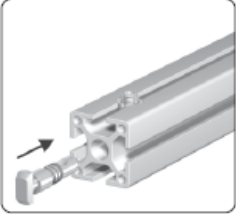
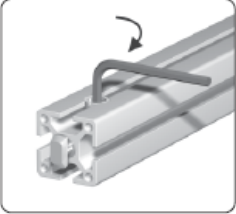
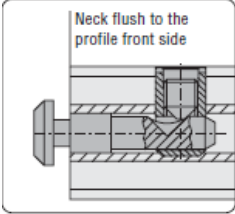
# Assembly hints

CONNECTOR	1.21.4E0	Connector, universal	<div><div><p>Insert the cross bushing</p></div><div><p>Push in the anchor</p></div><div><p>Pretension the anchor</p></div><div><p>Neck flush to the profile front side</p></div><div><p><b>Comments</b></p><p>For the optimal assembly of the profiles the connector is to be installed in such a way that the neck is flush to the profile front side</p></div></div> <div><p>Most MayTec connectors follow these assembly steps. Tightening torque is: 5-15 Nm for 20mm profiles, 30 Nm for 30mm group, 35 Nm for 40mm and larger profiles.</p></div>
CONNECTOR	1.21.4EK1	Connector, oblique-hinge l. + r.	<div></div> <div><p>This type of connector assembles similar to universal connector</p></div>